

The industry's preferred choice of maintenance free privacy track systems providing enhanced personal welfare throughout the entire healthcare and public sectors.

**GROSVENOR**  
CONTRACTS.COM



[grosvenorcontracts.com](http://grosvenorcontracts.com)

Hassle-free screening systems

# Grosvenor Contracts

## The cubicle track range

The industry's preferred choice of privacy track systems providing enhanced personal welfare throughout the entire healthcare and public sectors.

With aluminium profiling for long life durability, Biosafe accreditation for effective infection control, and aesthetic qualities to blend it in anywhere, the Grosvenor Contracts system has been developed with the user in mind.



## Preferred

It's not difficult to see what makes Grosvenor Contracts tracks a preferred choice throughout the industry from architects and contractors, to nursing staff and clinicians alike. It starts off with small differences like the free-running, snag-free roller wheeled curtain hooks, and the unique press-slide curtain removal point which allows curtains to be removed and replaced swiftly. Then there's the dependability of the rigid aluminium track profile and its ability to be able to span 3m between hangers. Find out more inside.

## O&M Guide

Grosvenor Contracts tracks cubicle and IV track systems require no maintenance other than normal cleaning procedures. Both the structural track and associated components are made from durable materials and will not corrode in normal use. In the event of damage, or wear and tear of moving parts, all components are readily available from the manufacturers or their dealers.

## The full range of Grosvenor Contracts Tracks

### 100 Cubicle Track 6

Premium quality fixed aluminium track system providing high levels of privacy and dignity and ensuring long term, maintenance-free reliability.

### 101 Mobile Track 8

Unique aluminium cubicle track system offering the convenience of adjustable screen positioning for revolutionary space utilisation.

### 300 Telescopic Divider Rail 10

Wall mounted, folding telescopic divider rail system designed to provide instant privacy screening in areas where a permanent ceiling fixture is not suitable.

### Movagate 11

Movagate is a spring-loaded hinge system that allows a hoist to pass through a cubicle track whilst maintaining patient privacy.

### IV200 Support Tracks 12

Heavy duty, ceiling mounted overhead intravenous track system providing stable means of item placement and freeing up valuable floor space.

### IV400 Support Tracks 14

Medium duty, suspended overhead intravenous track system for drip bags and associated accessories.

# Grosvenor Contracts Cubicle & Track Systems

All Grosvenor contracts systems are carefully built to exacting standards, giving years of trouble-free service. The superior design features and quality components enable them to be confidently specified for the most demanding environments.

All Grosvenor Contracts systems are constructed from premium grade, maintenance-free aluminium for hassle-free requirements, and can be found working effectively in hospitals, clinics, sports centres, schools and other public buildings.

The Grosvenor contracts cubicle track programme is one of the most highly regarded in the UK, offering simple telescopic divider rails for areas of restricted space through to large scale, permanent suspended fixtures for entire hospital solutions.

The Grosvenor contracts range of curtains has been developed to provide an in-stock solution and perfect accompaniment to the Grosvenor Contracts. It encompasses a full anti-bacterial portfolio ranging from disposable to high grade, machine washable. All of which are flame-retardant to government standards.

All Grosvenor Contracts systems are available in fully made to measure form completely ready for installation, or in a comprehensive individual component form for ease of use within any in-house manufacturing facility. The full range is distributed globally through a network of dealers and customers providing an unrivalled level of support, and with experienced installation and service teams to exceed your expectations.



A 12-month warranty applies to Grosvenor Contracts cubicle tracks when used in conjunction with Grosvenor Contracts curtains.



Solar panels on our production factory generate electricity needed to manufacture our products.



## The Grosvenor Contracts Cubicle Track System

### What unique features make this cubicle track system so popular?

All areas of the care community; hospitals, clinics, and health conscious institutions all over the world treat the care of their service users with a very high level of interest. To enable them to uphold an environment that is conducive towards peace, calm and recovery requires equipment and systems that are simple to use and require nominal on-going maintenance. Not only does installing these features pay dividends towards carer job satisfaction, they ultimately help the longevity of the care plan by ruling out the requirements of continual maintenance costs.

### With an ever-increasing host of options available to the healthcare sector, why should more thought go into a cubicle track system?

Many systems available provide only the minimum number of factors required to offer a suitable privacy solution, suiting contractor budget constraints rather than ensuring staff and service user well-being. For help when making your next decision, or to check how your current system fares in regard to the industry standard, have a quick read through the points listed below. If you would like a non-obligatory view of your present system from an unbiased advisor, please call the specialist support team on +44(0)20 7237 0099.

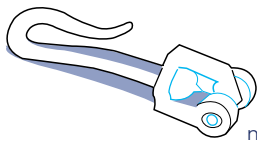

#### Roller Wheel Curtain Hooks

The free-running roller wheel curtain hooks offered with the Grosvenor Contracts system as standard never cease to be noticed by nursing staff who had grown accustomed to ordinary cubicle track systems. Even after years of use, curtains using these will be light and easy to draw. They won't even jam on bends!

#### Hassel-free

Ideally suited for all contract applications, the Grosvenor Contracts profile has a hygienic, wipe-clean, white powder-coated finish as standard. The machined flat top profile allows for positive wiping, providing absolutely no area for dust to build up nor bacteria to develop.

#### Premium Aluminium Profile

The core of the Grosvenor Contracts system is based around its sturdy, yet unobtrusive, profile. High grade aluminium and with no additional separate parts upholds the integrity of the product allowing it to span 3.0m between supports with no flexing or sag.

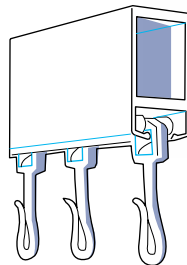

#### Cubicle Numbering System

The separating of individual bed bays by means of a numbering system is an absolutely essential form of identification in hospitals, clinics, surgeries and the like. The clearly visible design of the

Cubicle Numbering System provides a perfect solution to all open ward requirements. They ensure clear, instant and permanent visibility and yet still offer the convenience of tool-free repositioning whenever required.

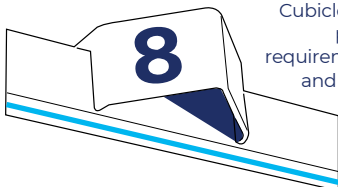

#### Suitable for Anti-Ligature

Only a system of compatible standards would be acceptable for the only 100% fail-safe anti-ligature solution available globally. That's why the Grosvenor Contracts cubicle track is the only system approved for use with the Grosvenor Contracts Anti-Ligature System.

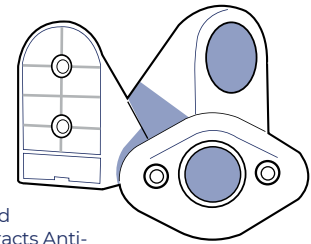

#### Curtain Removal Point

Every track gets fitted with a unique press-slide curtain removal point, allowing curtains to be removed swiftly, complete with hooks. It is of no surprise that this alone reduces maintenance time and improves infection control. No more attempting to remove soiled curtains from the track height at a stretch!

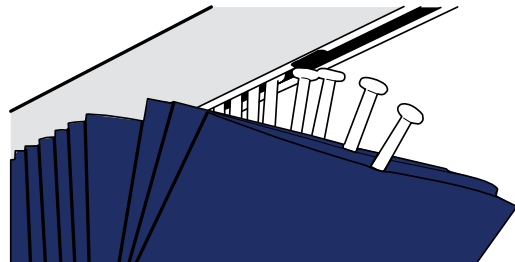

#### Installer friendly

Not only do nursing staff prefer the ease of use, many installers would rather fit Grosvenor Contracts than any other profile. The simple, elegant design is not only quick and easy to install, it is more satisfying. Die-cast aluminium wall shoes hold the track securely and slim suspension hangers exceed NHS strength requirements.

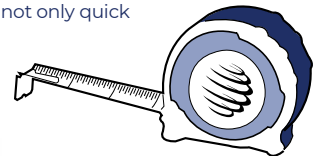

#### HTM66 Compliant

The Grosvenor Contracts system complies fully with the requirements of the NHS Estates Health Technical Memoranda Building Components Series 66. All details can be provided upon request.

#### Biosafe Antibacterial Accreditation

Biosafe is an internationally recognised accreditation meaning our systems have been tested under the most stringent measures to ensure effective inhibition of infection. A Biosafe accreditation means this product is anti-microbial and plays an active role in inhibiting illness.



# 100 Cubicle Tracks



## 100 Cubicle Track

### Features:

The rigid, high-grade aluminium track section and maintenance-free, wheeled roller hooks are just an introduction to the many features of the Grosvenor Contracts 100 cubicle track system, which is in use in many hospitals globally. Designed to give years of trouble-free service, this cubicle track system uses die-cast aluminium wall shoes for a secure position where tracks meet the wall, and suspension hangers for a rigid connection to the ceiling, unless directly ceiling fixed. Supplied with a curtain removal point as standard.

### Benefits:

Strength and simplicity make the Grosvenor Contracts 100 track system the first choice for a full number of applications. The maintenance-free, premium quality track system has a strong and attractive aluminium profile which offers you more for less, in that it is able to span 3.0 metres between hangers,

providing long term reliability. In a similar fashion, curtain removal points are provided as standard on every track for added convenience when replacing curtains. The self-lubricating roller runner hooks are quickly loaded into the track through this point of access. Complies fully with the requirements of HTM66.

### Options:

Silver anodised track; Any RAL colour available to order; Biosafe antibacterial treatment option available within white powder-coated finish only; Cubicle numbering system; Track mounted uplighters; Stainless steel roller hooks or rings.

### Grosvenor Contracts shower track:

Ideally suited for use as a shower track in washroom environments due to hygienic, wipe-clean properties.

### Specification:

The Grosvenor Contracts 100 cubicle track system as manufactured by Yewdale, +44 (0)20 7237 0099. Track manufactured from premium quality aluminium with silver anodised / white powder-coated finish, able to span 3.0 metre without support. Double hangers to ensure full functionality of system. Complete with roller runner hooks at 10 per metre, curtain removal points per section and, overlaps as necessary, spaced in accordance with manufacturers recommendations. Flame retardant curtains from the Grosvenor Contracts Curtains range. Layout as shown on accompanying drawings. Fitting to be carried out by trained and accredited personnel.

**Grosvenor Contracts tracks is the only approved cubicle track system to be used with Grosvenor Contracts Curtains for anti ligature use.**

BIM model available

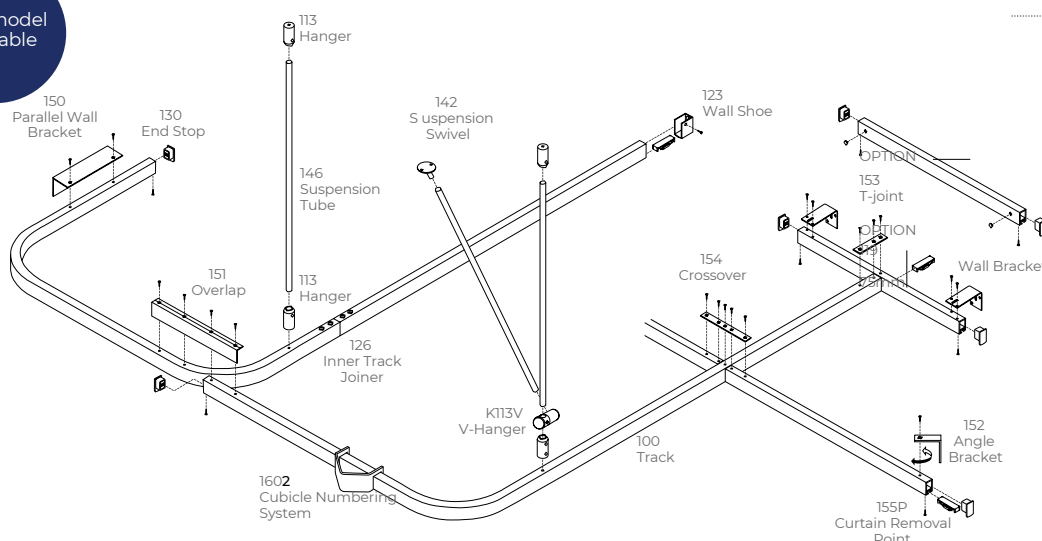

# Grosvenor Contracts Cubicle Track



## 100 Cubicle Track

### Features:

The rigid, high-grade aluminium track section and maintenance-free, wheeled roller hooks are just an introduction to the many features of the Grosvenor Contracts 100 cubicle track system, which is in use in many hospitals globally. Designed to give years of trouble-free service, this cubicle track system uses die-cast aluminium wall shoes for a secure position where tracks meet the wall, and suspension hangers for a rigid connection to the ceiling, unless directly ceiling fixed. Supplied with a curtain removal point as standard.

### Benefits:

Strength and simplicity make the Grosvenor Contracts 100 track system the first choice for a full number of applications. The maintenance-free, premium quality track system has a strong and attractive aluminium profile which offers you more for less, in that it is able to span 3.0 metres between hangers, providing long term reliability. In a similar fashion, curtain removal points are provided as standard on every track for added convenience when replacing curtains. The self-lubricating roller runner hooks are quickly loaded into the track through this point of access. Complies fully with the requirements of HTM66.

### Options:

Silver anodised track; Any RAL colour available to order; Biosafe antibacterial treatment option available within white powder-coated finish only; Cubicle numbering system; Track mounted uplighters; Stainless steel roller hooks or rings.

### Grosvenor Contracts shower track:

Ideally suited for use as a shower track in washroom environments due to hygienic, wipe-clean properties.

### Specification:

The Grosvenor Contracts® 100 cubicle track system as manufactured by Yewdale, +44 (0)20 7237 0099. Track manufactured from premium quality aluminium with silver anodised / white RAL 9016 Satin powder-coated finish, able to span 3.0 metre without support. Double hangers to ensure full functionality of system. Complete with roller runner hooks at 10 per metre, curtain removal points per section and, overlaps as necessary, spaced in accordance with manufacturers recommendations. Flame retardant curtains from the Grosvenor Contracts range. Layout as shown on accompanying drawings. Fitting to be carried out by trained and accredited personnel.

**Grosvenor Contracts is the only approved cubicle track system to be used with Grosvenor Contracts Curtains for anti-ligature use.**

100 Cubicle Track isometric drawing:

BIM model available

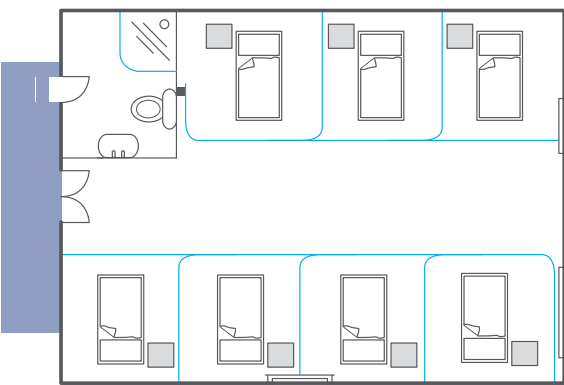
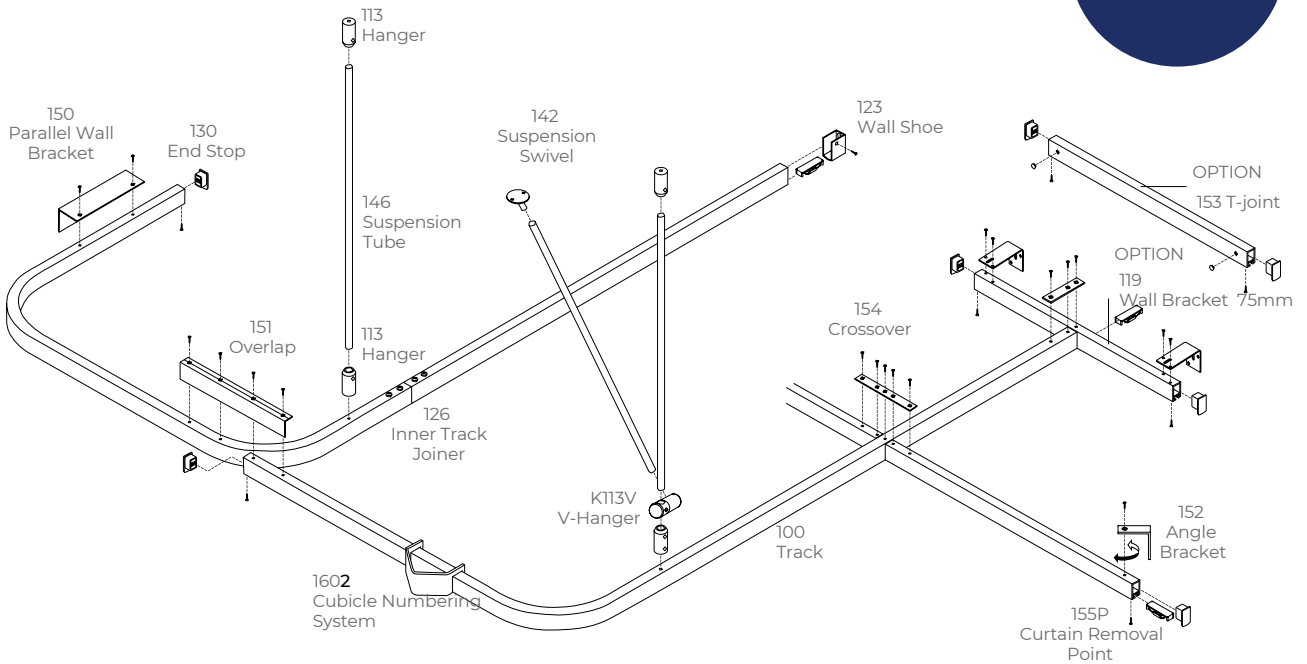

An example of a typical ward layout, showing how Grosvenor Contracts 100 provides optimum service user privacy.



# 101 Mobile Track

grosvenorcontracts.com Mobile Track



## 101 Mobile Track

### Features:

The rigid, high-grade aluminium profile section provides a perfect core to the mobile dividing rails of the Grosvenor Contracts 101 mobile cubicle track system. This unique system is supplied as standard in a white powder-coated finish and utilises maintenance-free, wheeled roller hooks for jam-free use. White suspension hangers fitted equidistant along the track length for suspended track solutions or directly mounted to the ceiling as required. Moveable cubicle tracks within the outer frame as required. Designed to give years of trouble-free service, this cubicle track system uses die-cast aluminium wall shoes for a secure position where tracks meet the wall, unless directly ceiling fixed. Supplied with a curtain removal point as standard.

### Benefits:

The mobile dividing rails of the Grosvenor Contracts 101 mobile cubicle track system are a unique feature that revolutionises space utilisation in hospital wards. Cubicle widths can be altered in seconds by nursing staff in response to changes in medical requirements such as patient care or amount of equipment needed. If a spare dividing rail is provided, an extra bed-space can be brought quickly into use if required - with patient privacy upheld and maintained. The system comprises of a track, with curtains, across the front of a row of bed cubicles, and a back track, without curtains, fixed to the wall behind the beds. Mobile trolleys run within special slots in these tracks, and carry the mobile dividing rails, with curtains, smoothly and quietly on neoprene-tyred wheels. Grosvenor contracts 101 includes all the advantages of Grosvenor Contracts 100 cubicle track and is fully compatible with it. The strong aluminium sections have a white powder-coated finish as standard.

### Options:

Any RAL colour available to order; Cubicle numbering system; Stainless steel roller hooks or rings.

### Grosvenor Contracts IV:

The Grosvenor Contracts IV400 overhead intravenous track system may be fitted to Grosvenor Contracts 101 with a mobile IV track, complete with 2-point carrier, running between, and parallel to, the mobile curtain tracks. This gives overhead IV provision at any point within the cubicle and augments the amazing versatility of the system. For further details see page 12.

### Specification:

The Grosvenor Contracts 100 cubicle track system as manufactured by Yewdale, +44 (0)20 7237 0099. Track manufactured from premium quality aluminium with silver anodised / white RAL 9016 Satin powder-coated finish, able to span 3.0 metres without support, and including all necessary fittings. Mobile dividing rails fitted with wheeled trolleys running within front and back tracks. Double hangers to ensure full functionality of system. Complete with roller runner hooks at 10 per metre, curtain removal points per section and, overlaps as necessary, spaced in accordance with manufacturers' recommendations. Flame retardant curtains from the Grosvenor Contracts Curtains range. Layout as shown on accompanying drawings. Fitting to be carried out by trained and accredited personnel.

## 101 Mobile Track isometric drawing:

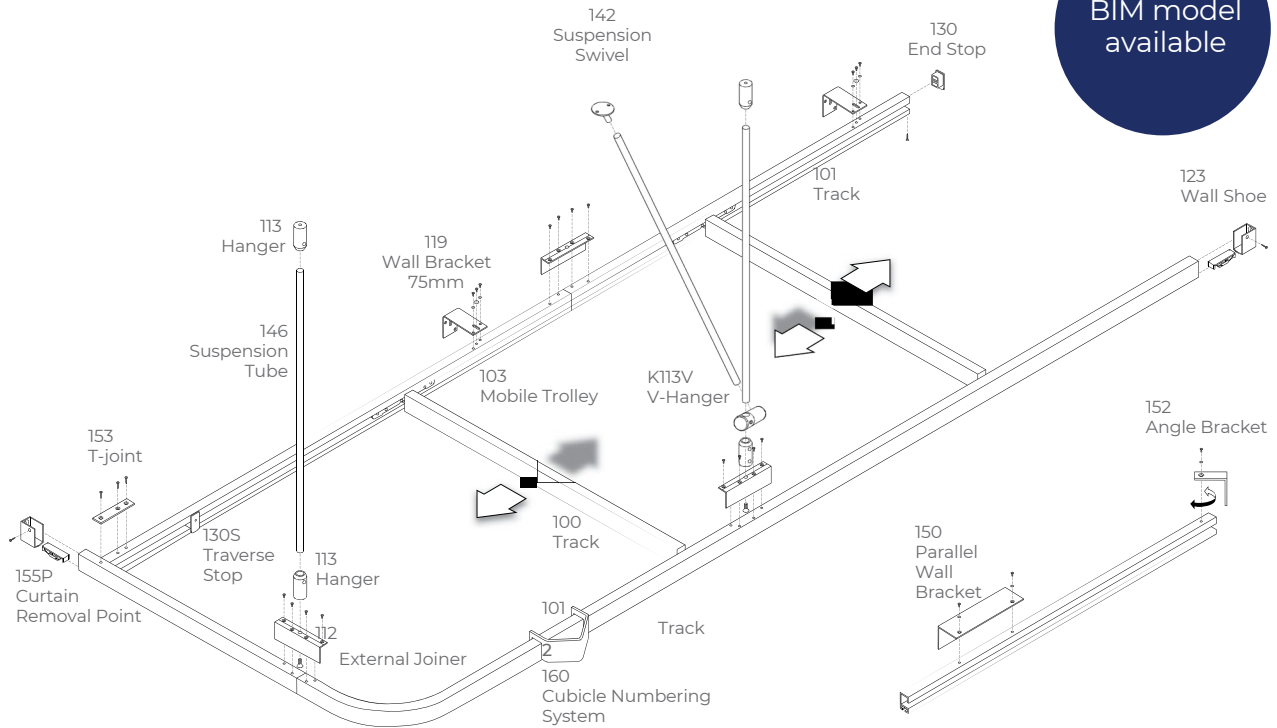

BIM model available

An example of a typical ward layout showing the versatility of Grosvenor Contracts 101. Mobile tracks can be moved to instantly create more space around a bed.

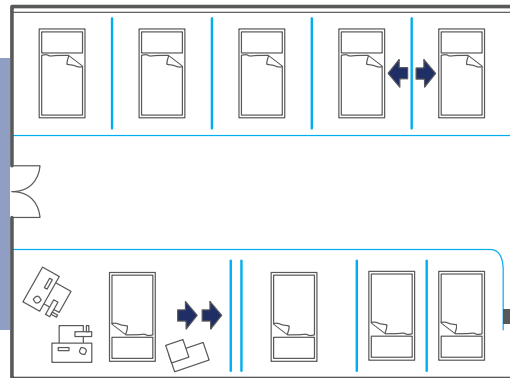

### 101 adapts to your ward's needs:

Many hospitals struggle with the conflicting requirements of additional bed space and fixed cubicle curtain tracks. When extra bed spaces are required often the arrangement of the fixed cubicle tracks restricts the possibility of providing additional suitable areas even though space may physically permit. This is where Grosvenor Contracts 101, with its mobile dividing rails, has the answer. In the illustration, A & B are two spare tracks, with curtains stacked at front of the track. There are currently 3 equally-sized bays available.

There is physical space available to add an extra bed however the cubicle tracks prevent the accommodation of an addition. No problem. Track B is moved away from the wall to the right and makes a new bay. Beds 1 - 3 move to the right along with tracks B, C & D creating 4 equal bays; the extra bed is wheeled into position between curtain B and the wall as shown. It is important that service user privacy is maintained at all times, and Movatrack 101 fulfils this simply and ingeniously.

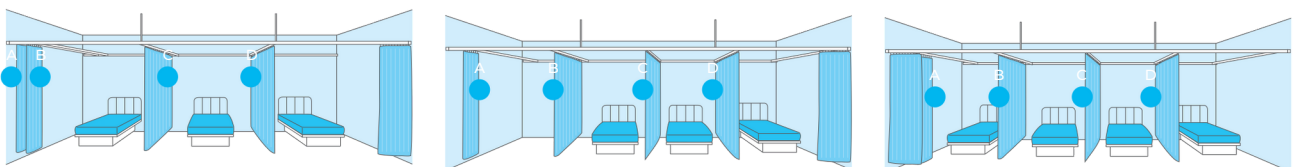

# 300 Telescopic Divider Rail

grosvenorcontracts.com Telescopic Divider Rail

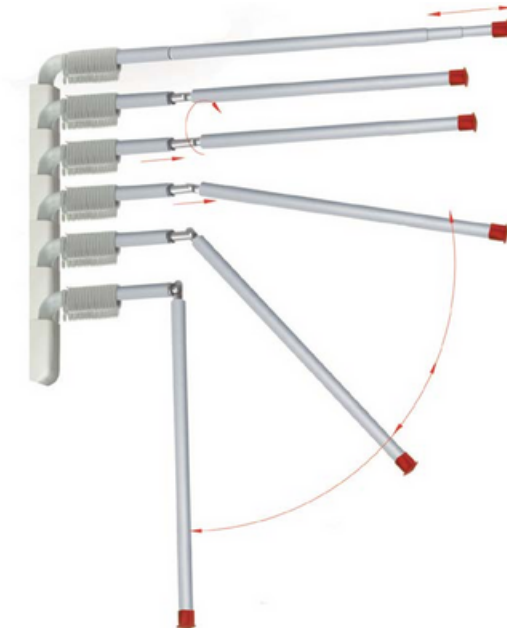

## 300 Telescopic Divider Rail

### Features:

The Grosvenor Contracts 300 telescopic divider rail has a high-grade, yet lightweight aluminium wall mounted rail as standard. The folding mechanism utilises aluminium components for long-term reliability. The curtain arm is adjustable in length up to 2100mm depending on the model. Curtains are mounted to the rail by large plastic loops for ease of application.

### Benefits:

Grosvenor contracts 300 is designed specifically for doctors surgeries, hospitals, and other healthcare institutes where space and privacy needs conflict, or where a fixed track is not suitable. This unique system revolutionises space utilisation and caters for overhead hoists and other lifting equipment. The system comprises of a telescopic divider rail with light weight flame retardant curtains, that can go from its almost unseen closed position against the wall, to a full screen in 10 seconds. By having the choice of length of telescopic arms along with colours of curtains, ensures the product fits well within its environment.

### Specification:

The Grosvenor Contracts 300 telescopic divider rail as manufactured by Yewdale +44 (0)20 7237 0099. Lightweight telescopic aluminium track and curtains with unique fold-down mechanism. Flame retardant curtains from the YewdaleHarrier® range.

### Telescopic rail specification guide

Part No.	Description	Size
300 / 21	Telescopic Divider Rail	1000 - 2100mm
300 / 16	Telescopic Divider Rail	800 - 1600mm
300 / 13	Telescopic Divider Rail	700 - 1300mm

# Movagate



## Movagate

### Features:

The Movagate is the ultimate solution for suspended curtain track system cubicle tracks where there is a requirement for a hoist. Designed with a robust sprung-loaded hinge and magnetic latch technology, the Movagate allows the hoist to pass swiftly and easily through the track whilst maintaining 100% patient privacy at all times. The maintenance-free Movagate is supported with white suspended V-hangers to ensure a firm and positive installation. White powder-coating incorporating Biosafe antimicrobial treatment.

### Benefits:

The Movagate provides the ultimate solution. Due to the rigidity of the Grosvenor Contracts cubicle track system, this simple but effective solution is designed to be retro-fitted to any existing Grosvenor Contracts arrangement or installed with a new installation

of Grosvenor Contracts cubicle track. Available worldwide, Movagate has enabled Architects, Trusts and Contractors to approach both patient handling and privacy in a new light and is now revolutionising the design of patient areas.

### Specification:

The Movagate as manufactured by Yewdale, +44 (0)20 7237 0099. Extruded aluminium track with white RAL 9016 Satin powder-coated finish incorporating Biosafe antimicrobial treatment. To be suspended with white V-hangers in line with Grosvenor Contracts cubicle tracking (at 2.1m above floor level or as specified) in accordance with manufacturer's instructions. Layout as shown on accompanying drawings. Fitting to be carried out by trained and accredited personnel.

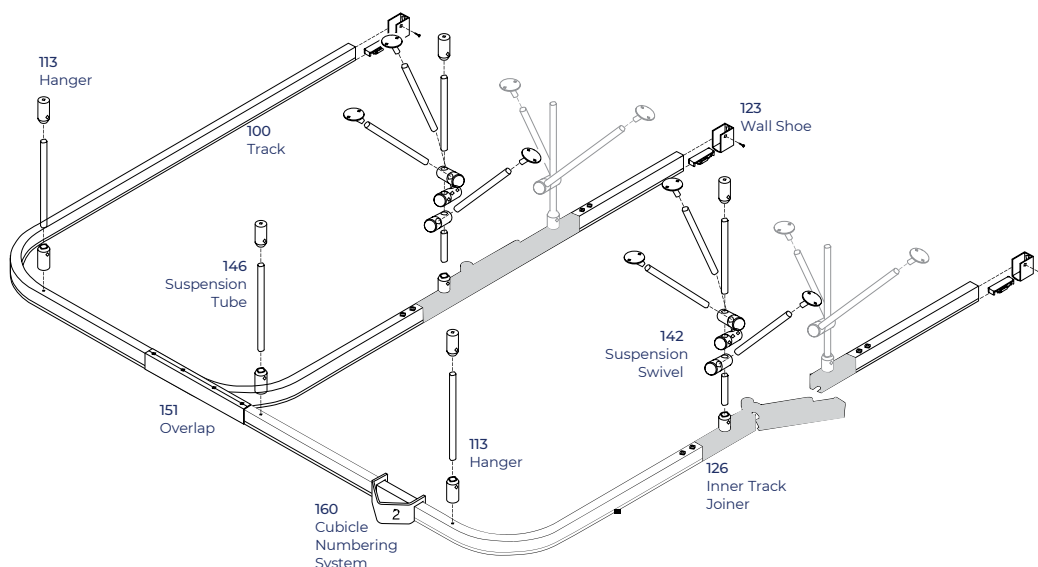

# Grosvenor Contracts Intravenous Track System

grosvenorcontracts.com Intravenous Track System



BIM model available

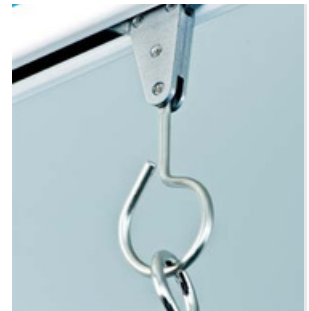

## IV200 Heavy Duty Intravenous Support Track

### Features:

The Grosvenor Contracts IV200 heavy duty intravenous support track is machined from rigid, high-grade aluminium profile section and mounts directly to the ceiling as standard. This unique system is supplied as standard in a hygienic, white powder-coated finish and utilises heavy duty, self-locking wheeled trolleys for dependable support.

### Benefits:

It is becoming increasingly important that the area around a hospital bed should be as uncluttered as possible. It is now accepted that the patients' quality of life can have a direct bearing on recovery time, and the perceived intrusiveness of medical equipment may be a contributory factor. The benefit of Grosvenor contracts IV200 is not only that drip bags and equipment are taken off the floor, but that they are suspended from an overhead track. IV provision can be kept discreetly aside, without taking up valuable floor space, yet it is always available to be moved into position when required. IV200 track is a very strong and rigid aluminium extrusion with a white powder-coated finish. It is usually fixed directly to the ceiling, although it may be suspended if the ceiling height is over 3m. Locking trolleys run smoothly and quietly within the track section on tough nylon wheels. When a carrier tree or pump carrier is suspended from a locking trolley, the trolley will automatically lock into position on the track to prevent accidental movement.

### Options:

Telescopic carrier trees available in four sizes to suit a range of track heights; all have simple release adjustment for accurate height control of the five stainless steel hooks. Pump carriers have a 20mm diameter pole to which syringe and infusion pumps may be clamped; they can be used alone for syringe pumps, or positioned alongside a carrier tree for infusion use, and with a load capacity of 30kg will take up to four pumps with ease. The optional pump carrier with power supply solves the problem of cable management, with an NHS specification supply cable attached to the top of the pump carrier and across to the wall at ceiling height.

### Specification:

The Grosvenor Contracts IV200 Overhead intravenous track system as manufactured by Yewdale, +44 (0)20 7237 00990. Heavy duty, white RAL 9016 Satin powder-coated aluminium track, ceiling-fixed in accordance with manufacturer's instructions. Telescopic intravenous carrier trees and pump carriers to be suspended from self-locking wheeled trolleys mounted within the track. Layout as shown on accompanying drawings. Fitting to be carried out by trained and accredited personnel.

### IV200 Loading figures

Part No.	Description	Design Load
210W	Heavy Duty IV Track Locking Trolley	80kg at each fixing point, therefore the capacity of the track is 80kg x the number of fixings, with load evenly distributed. Fixings should be at 1200mm maximum. If point loads exceeding 25kg (eg. heavy equipment) are anticipated, fixing is recommended at 800mm centres.
233	Telescopic Carrier	40kg
234W	Tree	Central Hook: 8kg, Folding Hooks: 3kg each. Total load: 20kg
235W	Pump Carrier	30kg

## IV200 Intravenous Support Track isometric drawing:

BIM model available

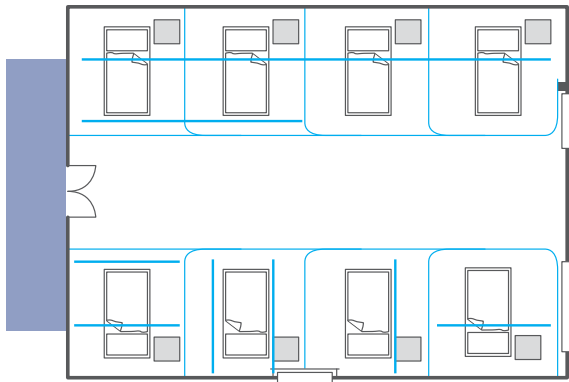
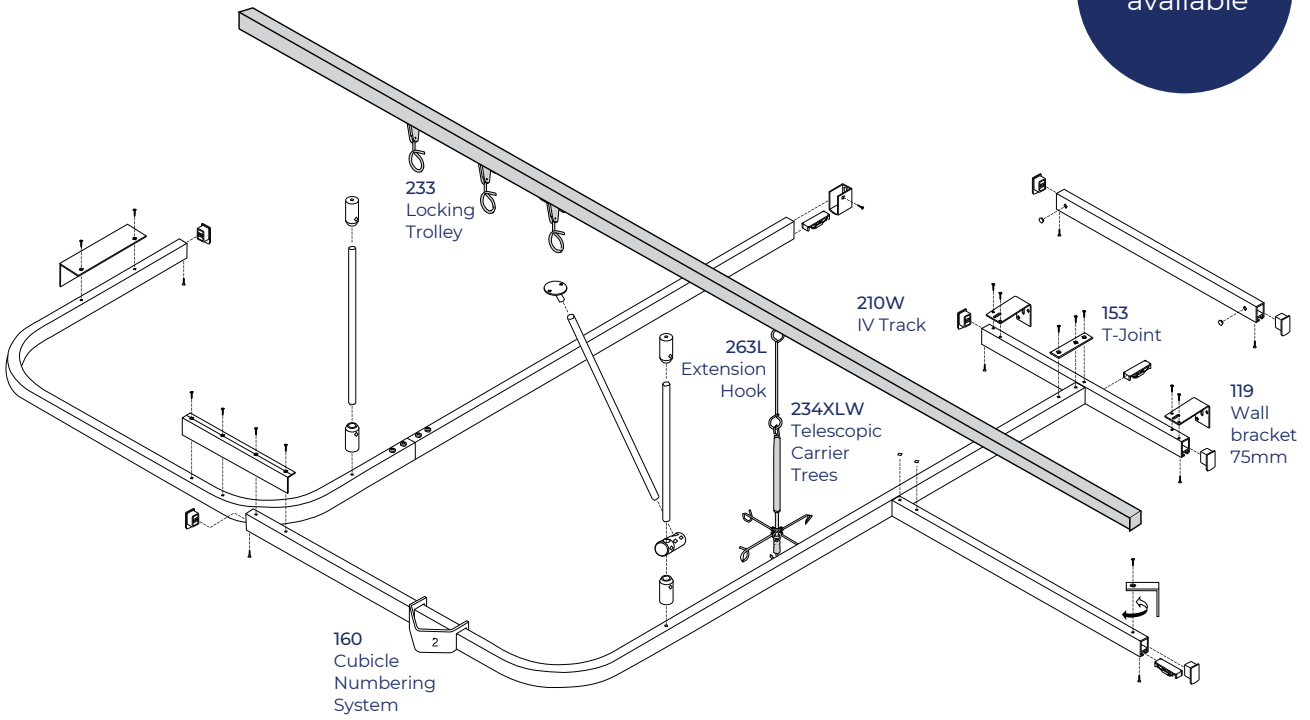

There are several alternatives for IV200 track positions. The most commonly used layout is a track parallel to the back wall and 1m out from it. A continuous track is then possible over the line of beds, assuming an unobstructed ceiling. A second track may be positioned across the foot of the beds if required. Another alternative is a track running parallel to the bed. This gives IV provision at both the head and the foot of the bed, and also allows stacking of carriers against a wall.

# Grosvenor Contracts Intravenous Track System

grosvenorcontracts.com Intravenous Track System



## IV400 Medium Duty Intravenous Support Track

### Features

The Grosvenor Contracts IV400 medium duty intravenous support track is machined from rigid, high-grade aluminium profile section and can be mounted directly to the ceiling or, more usually, suspended at cubicle track height of 2.1m. This unique system is supplied as standard in hygienic, white powder-coated finish and utilises economical 2-point drip carriers with nylon runners. Able to span 2.5 metres without support, and includes all necessary fittings.

### Benefits

The Grosvenor Contracts IV400 was designed specifically for the overhead suspension of drip bags without the need to use valuable floor space. This means that it is always available at a moment's notice, yet remains discreetly unobtrusive. As the carrier is track mounted, it can be moved to one side of the cubicle when not in use, and can be positioned at either side of the bed, or above it, if required. IV400 is very quick and simple to install. It is usually fixed to the existing cubicle curtain track using T-joints, and would only need extra suspension points where a long span is required. Each track is fitted with a press- slide carrier access point to enable extra carriers to be added at any time. The 2-point carriers run on low friction nylon runners in a channel within the track section and have two stainless steel hooks for drip bags, with a load capacity of 3kg per hook.

### IV400 Loading figures

Part No.	Description	Design Load
400W	Medium Duty IV	10kg at maximum span 2.5m
430W	Track 2-point IV Carrier	6kg (3kg per hook)

### IV Mobile

The Grosvenor contracts IV400 system in conjunction with the Grosvenor Contracts 101 mobile cubicle track system is a unique combination, giving full IV provision at any point within the cubicle. The traversing IV track is fitted with mobile trolleys at each end which run within the special front and back tracks of the cubicle track system. For more details on Grosvenor Contracts Mobile 101 see page 6.

### Specification

The Grosvenor Contracts® IV400 Overhead intravenous track systems as manufactured by Yewdale, +44 (0)20 7237 0099. Extruded aluminium track with white RAL 9016 Satin powder-coated finish to be suspended (at 2.1m above floor level or as specified) in accordance with manufacturer's instructions. 2-point carriers to be suspended from track on nylon runners. Layout as shown on accompanying drawings.

## IV400 Intravenous Support Track isometric drawing:

BIM model available

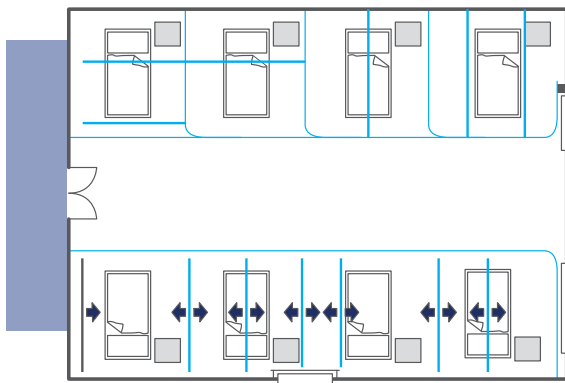
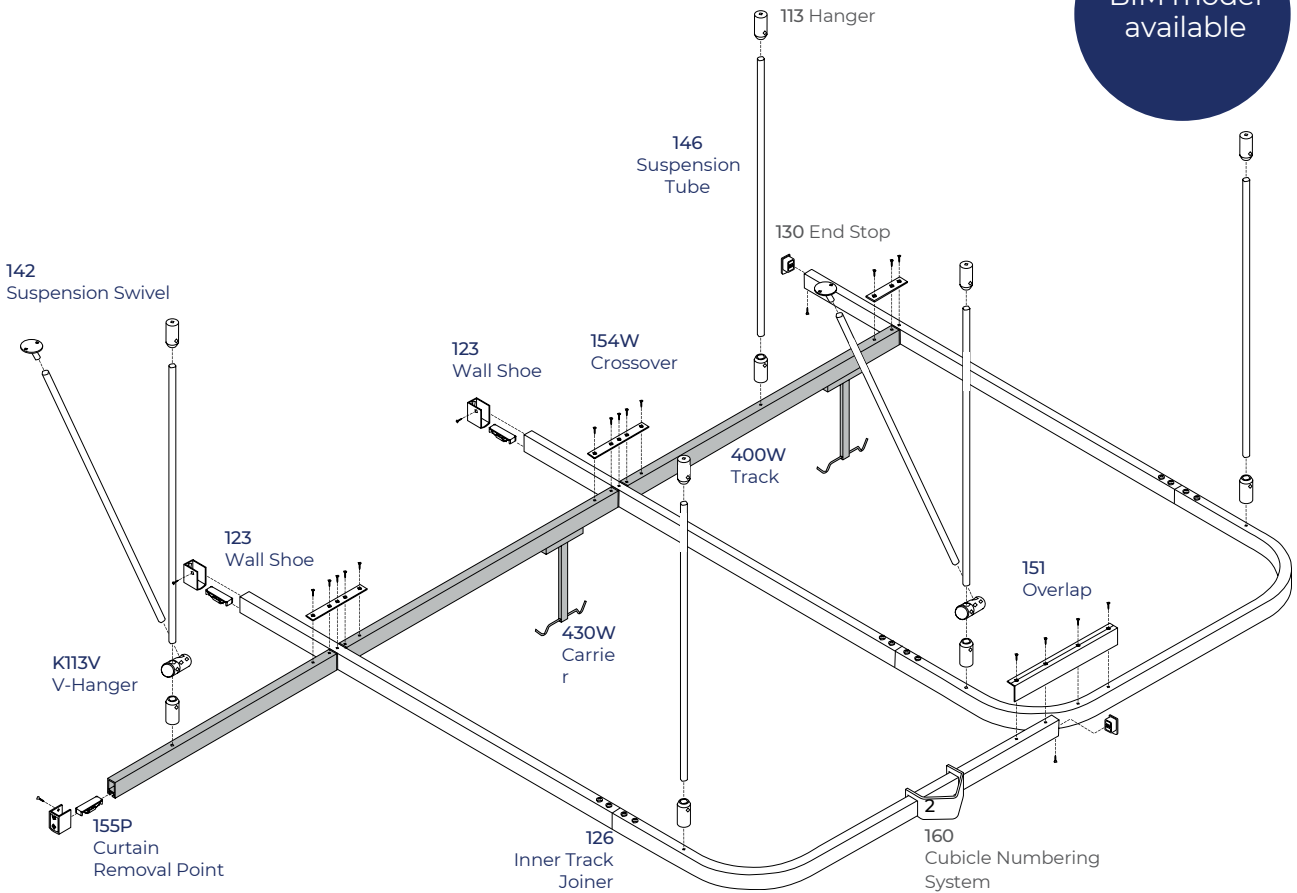

Grosvenor Contracts IV400 lends itself to many configurations within a hospital bed cubicle. The most common configurations of fixed track are shown here, but the specifier should take account of medical factors such as levels of usage, and the possible need of secondary IV provision at the foot of the bed.

The traversing IV tracks of Grosvenor contracts IV400 Mobile are shown here in conjunction with Grosvenor Contracts 101 Mobile cubicle track.

The versatility of the system is immediately apparent, giving total flexibility of both bed space width and positioning of IV provision within it